

# Ball Valve Lockout : Lockout Tagout

## Ball Valve Lockouts

Available in 3 sizes these easy to use lockouts clamp over the valve lever, preventing the valve from operating. Please note that LOK023 can lock valves in the open or closed positions, whilst the larger LOK024 & LOK025 can only be used in the locked position.

## Butterfly Valve Lockouts

Working in a similar way to the standard Ball Valve lockouts, the wedge on the slider section sits between the compression handle and lever, preventing operation.

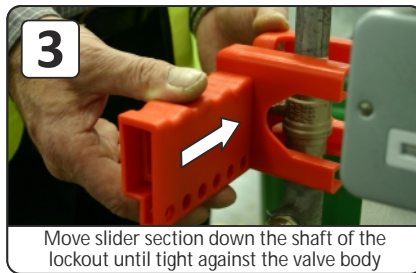
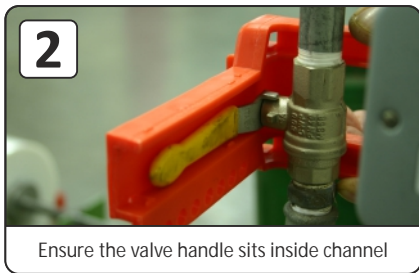
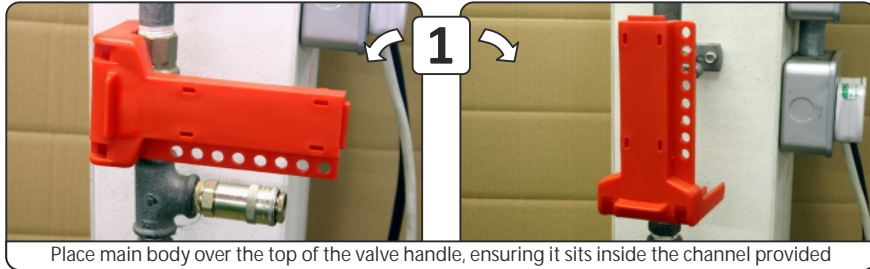

Please note that the holes on the slider have a staggered repeat which ensures that at least one hole will be tight when placed against the valve. If more than one padlock is required then a hasp should be used on the hole which keeps the slider as tight to the valve as possible.

## Ball Valve Lockout



Ball Valve Lockout	
Size	Code
9.5 - 31mm	LOK023
38 - 63mm	LOK024
50 - 203mm	LOK025

## Ball Valve Lockout

When slid into position the wedge on the slider section prevents the compression handle being squeezed, preventing operation of the valve.



Butterfly Valve Lockout	
Code	
LOK018	